

Developer :



Kokila Infratech Pvt. Ltd.

Kokila Residency, Plot No. 190/702
Ananta Vihar, Pokhariput, Bhubaneswar-751020
Ph. : +91 674 2352078, 2352079
E-mail : kokilainfratech@gmail.com

ORERA Regd. No. RP/19/20-21/00615



LIVING WITH ATTITUDE

Developer :



Kokila Infratech Pvt. Ltd.

Kokila Residency, Plot No. 190/702
Ananta Vihar, Pokhariput, Bhubaneswar-751020
Ph. : +91 674 2352078, 2352079
E-mail : kokilainfratech@gmail.com

ORERA Regd. No. RP/19/2021/00615

Project Consultant :



AAKAR ARCHITECTS

AAKAR ARCHITECTS
ISO 9001:2008 certified
N2/14, Nayapalli,
Bhubaneswar-751015
Telefax No. : +91 674 2551898
E-mail : aakar.architects@yahoo.co.in

Designed & Printed at :



IDCO Plot No. M-29, Near OTV
New IT Zone, Chandaka Industrial Estate
Patia, Bhubaneswar - 751 024
Tel. : +91 674 2976825, 94371 62825
E-mail : arttech.bbsr@gmail.com



LIVING WITH ATTITUDE

The brochure is not a legal document. It has been produced for the general promotion of the development and for no other purpose. All information contained in this brochure is taken from design intent material and may be subject to further design development. These details do not form any part of any contract and whilst every effort has been made to ensure their accuracy, this cannot be guaranteed and intending purchasers should not rely on them as statements or representation of facts.



THE ALTITUDE OF ATTITUDE



Soar above the others. Like an eagle, dominate the sky. Live the high flyer's life. Passionately crafted with the finest piece of architecture in recent times. Explore the euphoria for your senses with maximised panoramic views spread till the very horizon. Blessed with unique features, unseen anywhere in POKHARIPUT, the building is a vision of the future, being brought alive today. Techno styled and neo-minimalist design accentuations combined with avant-grade sculpture and water bodies evoke a sense of calm and serenity in a life, suited for winners. "Uncommon" your lifestyle ate the cradle of sophistication and exclusivity, as KOKILA ENCLAVE ANNEX unveils Latitude-the newest benchmark in exclusive new age living.



PROJECT
LAYOUT

TYPICAL
FLOOR
PLAN
BLOCK-A

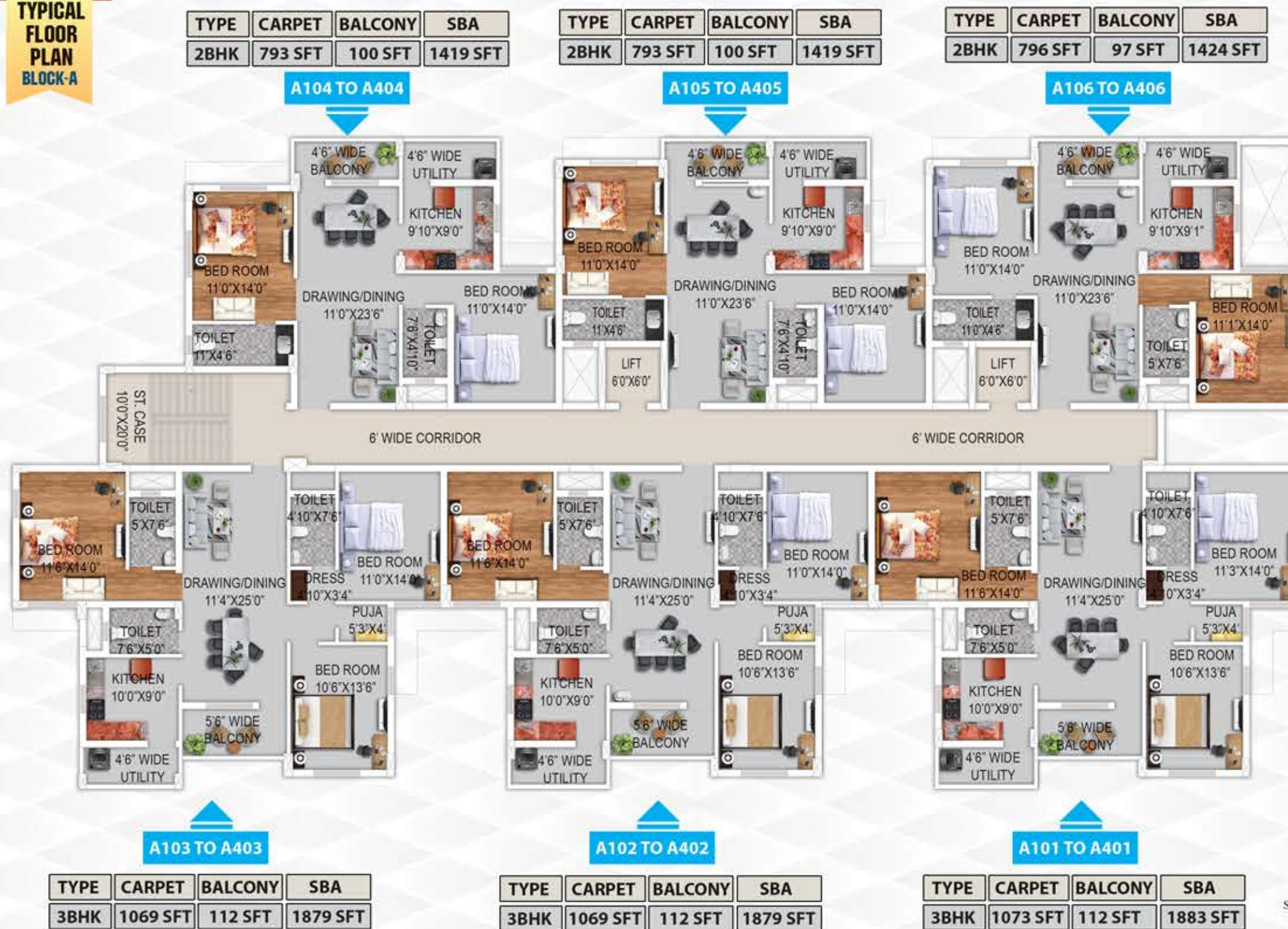





LIFESTYLE

As the professional lives of Kokila Enclave Annex residents change, so do their private lives. The rudimentary pastimes of a slower, more relaxed life has given way to focused pursuit of hobbies and activities that help people recharge and fit in tighter schedules. But more, importantly, these lifestyle preferences must find a space in your home. They still remained hopes rather than expectations, often a distant aspiration. Kokila will transform this skewed relationship between people and their preferences, turning lifestyle into a montage of sophisticated choices, where revelry and relaxation come in all shapes and sizes.

CHILDHOOD

The digital world has limited the horizons of children, within the bounds of a screen. Perhaps it's because the all-purpose open spaces, where children learned their most important lessons, are gone. Sometimes, transformation is about a return to the essence. That's how Kokila will transform childhood; by returning it to the peals of playground laughter, to the flights of imaginations in tree houses, and to the joy of unprecedented experiences.





FOR
LIFE'S
CONVENIENCES

COMMON
AMENITIES &
FEATURES

Gated Community
Gym

Society Room

Security Room

24 hrs. Water Supply

Swerage Treatment Plant

Intercom

Walking Track

Children Play Area

CCTV

300 wt Power Back-up/Unit





ALL
IN
THE
DETAILS

INCOMPARABLE IN ADDRESS. PARAMOUNT IN LIFESTYLE

Luxury is attention to detail, originality, exclusivity and above all, quality.

Kokila Enclave Annex is designed to be special in every way. Every day turns into a new experience in a building designed for the high flyer's life, literally. Exceptional in design and amenities, utterly private and incredibly captivating, Kokila Enclave Annex latitude is a destination beyond compare.

Structure

RCC framed structure. Fly Ash Bricks masonry work for walls.

Flooring Finishes

Vitrified floor tiles in living, dining, kitchen and bedrooms, balconies, kota/marble finish to the staircase. Matt finish floor tiles to the toilets.

Kitchen

Granite based kitchen top with stainless steel sink. 2' height ceramic tiles above granite top with modular points.

Doors

Main door : Bothside Veneered flush door.

All Other doors are of Company made flush door.

Windows

UPVC frame glass shutters.

Electrical

Premium quality copper wire with modular switches and fitting.

Provision for Telephone, A.C. and Geyser.

Sanitation

Wash basin in Dining area.

Closets, wash basins and health faucet in toilets.

Ceramic and CP fittings of standard quality & make.

Wall Finish

Internal Walls : Finished with two coat Putty.

External Walls : Finished with exterior weather coat paints.

Toilet Walls : Finished ceramic glazed tiles up to 7' height.

Staircase

Fitted with stainless steel railing / MS powder coated pipes.





LOCATION MAP

**DESIGNED FOR
COMPLETE
LIFESTYLES.**

